



# TRUCK BED CARGO UNLOADER 900KG

MODEL NO: TBU01

Thank you for purchasing a Sealey product. Manufactured to a high standard, this product will, if used according to these instructions, and properly maintained, give you years of trouble free performance.

**IMPORTANT:** PLEASE READ THESE INSTRUCTIONS CAREFULLY. NOTE THE SAFE OPERATIONAL REQUIREMENTS, WARNINGS & CAUTIONS. USE THE PRODUCT CORRECTLY AND WITH CARE FOR THE PURPOSE FOR WHICH IT IS INTENDED. FAILURE TO DO SO MAY CAUSE DAMAGE AND/OR PERSONAL INJURY AND WILL INVALIDATE THE WARRANTY. KEEP THESE INSTRUCTIONS SAFE FOR FUTURE USE.



Refer to instruction manual

## 1. SAFETY

- WARNING!** To prevent serious injury, read and understand all warnings and instructions before use.
- DO NOT** exceed rated weight capacity of this product.
- DO NOT** exceed rated weight capacity of pick up truck. Refer to pick up truck gross vehicle weight rating.
- DO NOT** use this product to unload anything over 900kg.
- DO NOT** use if any part(s) are damaged or not in place.
- WARNING!** Secure Roller Bar before driving. Failure to secure Roller Bar may cause Load Sheet to billow while driving, causing a traffic hazard.
- Before each use, clean pick up bed and Load Sheet. Dirt and debris can damage Load Sheet. Spray silicone lubricant (not included) around "L" Brackets and Crank Slot.
- Make sure tailgate is closed and latched.
- Open tailgate cautiously, load may shift or fall while opening.
- Assemble parts as per manual and ensure all parts are connected properly, with all screws, bolts and nuts secured tight.
- Keep unloading area clear before use.
- Always wear appropriate personal protective equipment for installation and use.
- Check total weight of the load before using this product.
- Check local regulations and vehicle condition before installing this product onto your vehicle.

## 2. INTRODUCTION

Simple crank system allows for quick unloading of cargo from your truck bed in a matter of seconds. Suited to compact and step-side truck beds with a max tailgate thickness of 9.5cm. Can unload cargo weighting up to 900kg. Quick set up and easy storage, crank is removable and only needed when clearing cargo. High quality polypropylene mat, designed to withstand high strain without tearing. Single person operation allows for pain free unloading of cargo, reducing risk of back injuries. Small wrench and easy assembly instructions included, securely fastens to tailgate without welding, cutting, or drilling. Suitable for all sorts of materials such as soil, gravel, mulch, clay, sand, refuse and firewood.

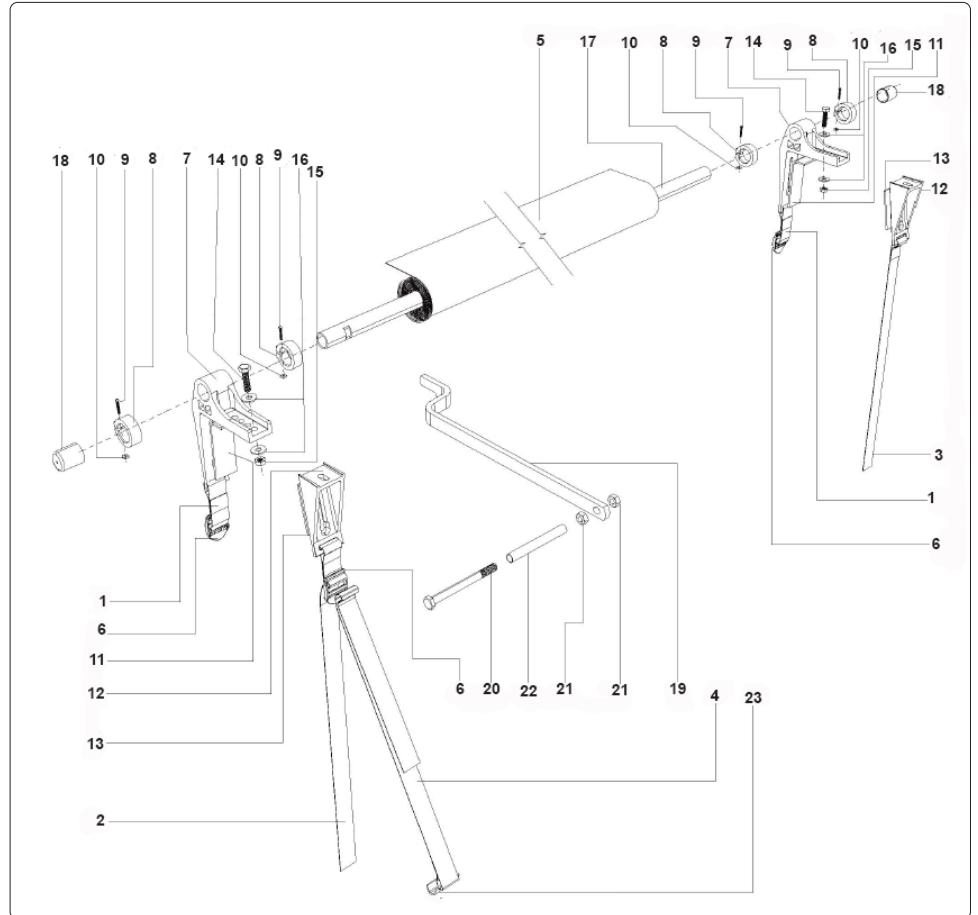
## 3. SPECIFICATION

Model No:..... TBU01  
Capacity:..... 900kg  
Dimensions: .....455 x 128cm

## 4. CONTENTS

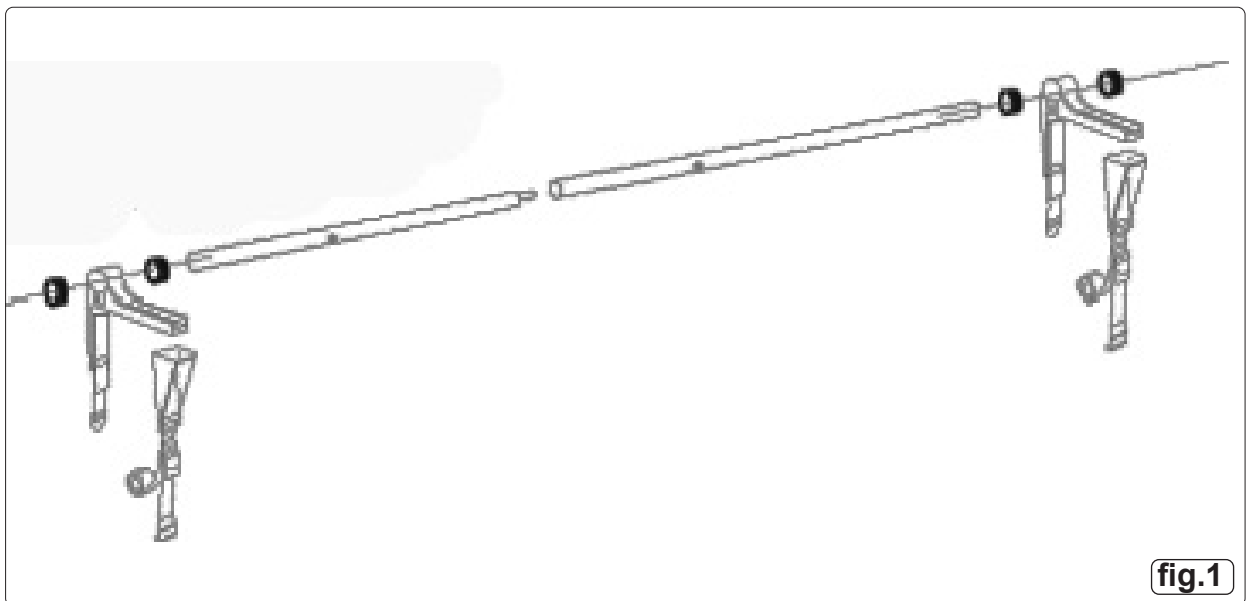
**NOTE** Ensure all parts are included then assemble this product as per instruction below.

Part	Description	Quantity
1	Buckle strap	2
2	Left Tailgate strap	1
3	Right tailgate strap	1
4	Bumper strap	1
5	Load sheet	1
6	Buckle	3
7	"L" Bracket	2
8	Bracket stop	4
9	Stop bolt	4
10	Stop nut	4
11	"L" bumper	2
12	Rear bracket	2
13	Rear bracket bumper	2
14	Bracket bolt	2
15	Bracket nut	2
16	Bracket washer	4
17	Roller bar	1
18	Roller bar cap	2
19	Crank	1
20	Crank bolt	1
21	Crank nut	2
22	Crank handle	1
23	Bumper hook	1



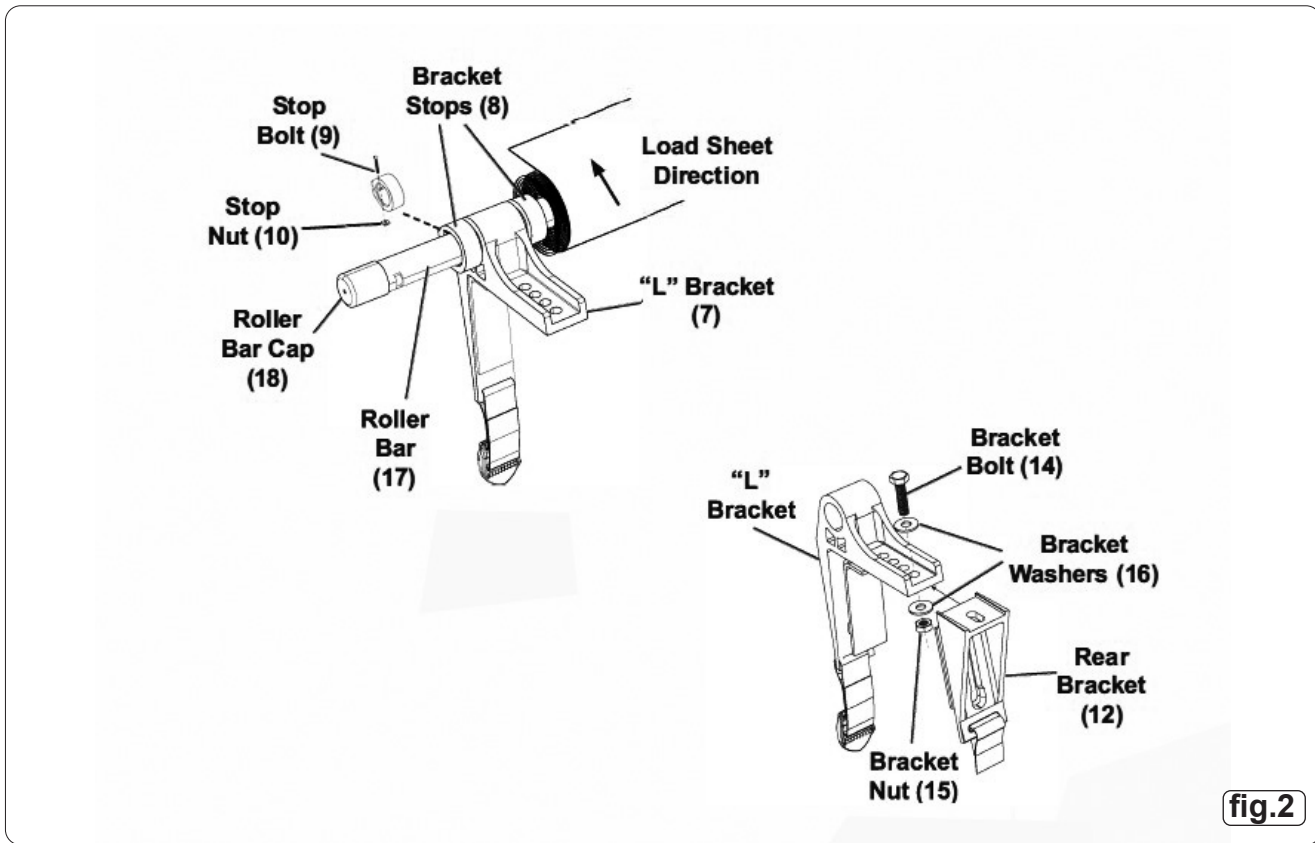
## 5. ASSEMBLY

- 5.1. Assemble this product as per instruction below. Hand tools such as spanners and wrenches will be required (not included).
- 5.2. Place parts below as per fig.1.

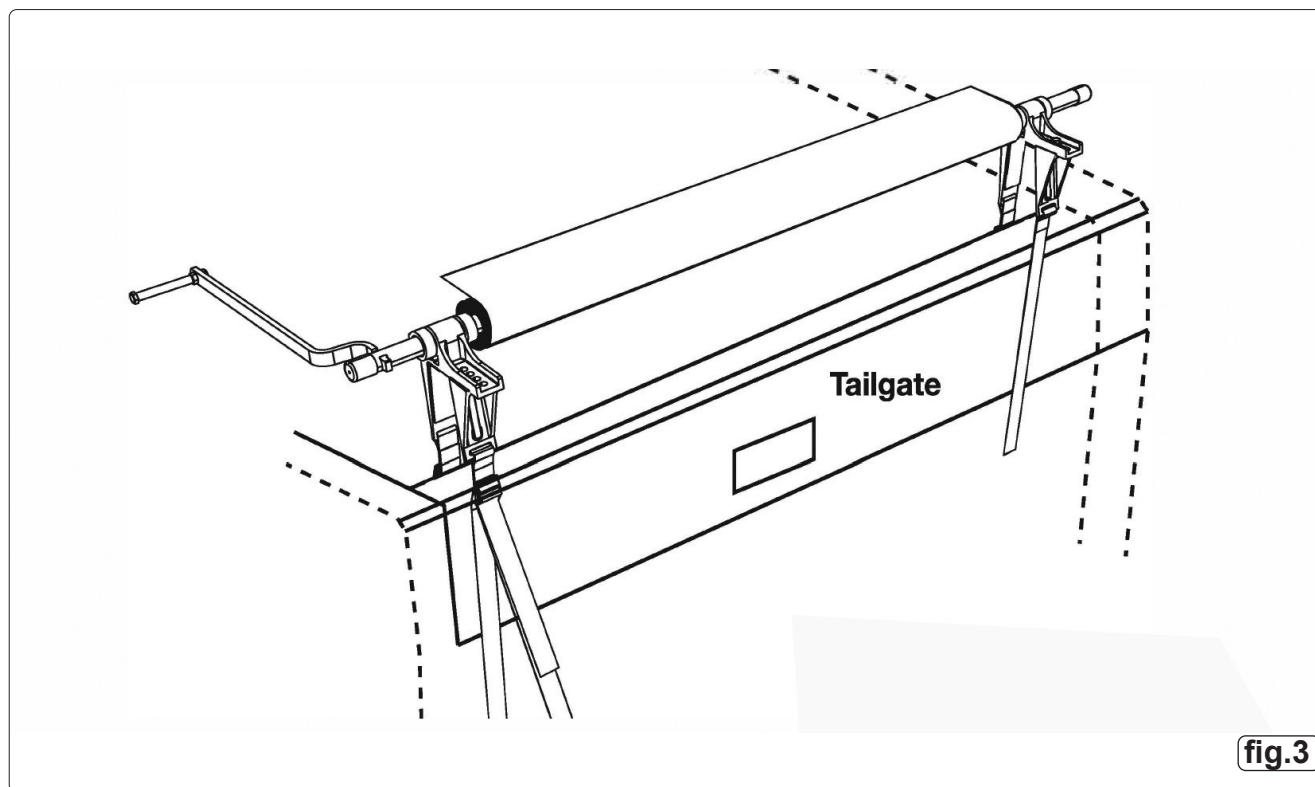


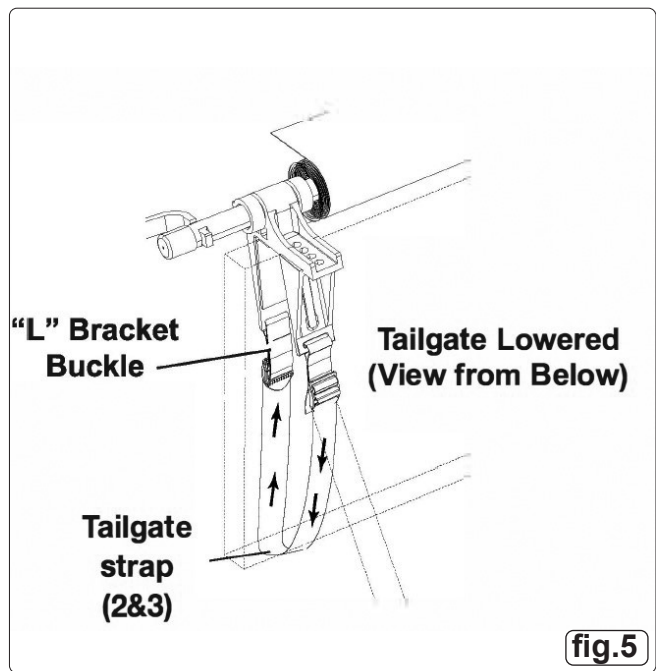
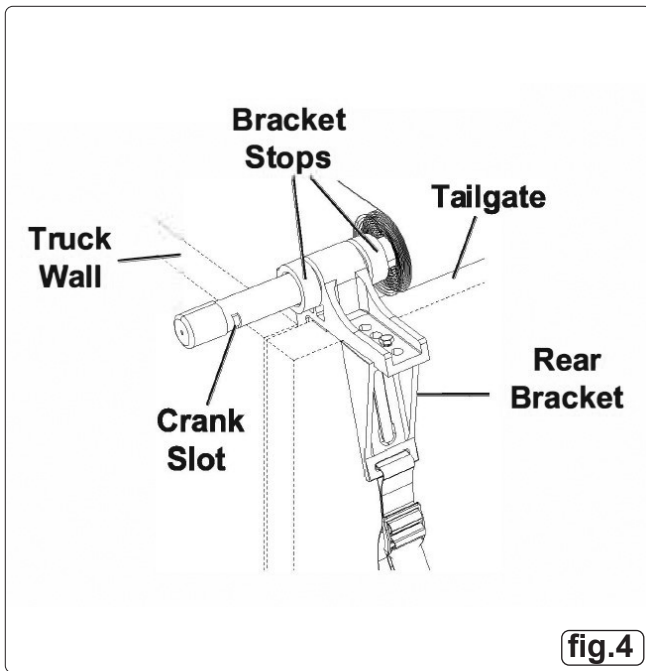
**fig.1**

5.3. Assemble using provided nuts, washers and nuts where required below and tighten fig.2

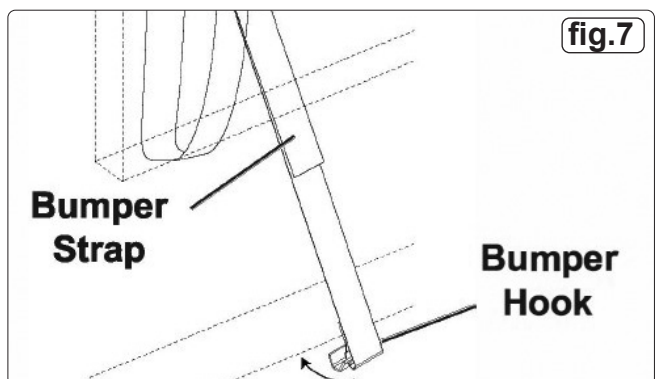
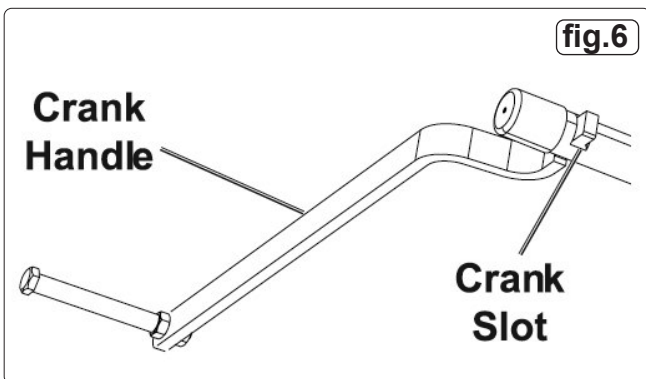


5.4. Place assembled unloader on tailgate, ready for installation as shown below fig.3





- 5.5. With tailgate closed and latched, position unit so that crank slot (See fig.4) is on passenger side outside edge of tailgate.
- 5.6. Slide bracket assemblies to inside edges of pick up walls and position bracket stops against bracket assemblies. Tighten hardware on bracket stops.
- 5.7. Adjust rear brackets until snug against tailgate, then tighten hardware (See fig.4).
- 5.8. Lower tailgate, then feed tailgate strap (2&3) through gap between tailgate and pick up bed, then up tailgate to "L" Bracket Buckles. Feed straps through Buckles and tighten slack by pulling strap (See fig.5).



- 5.9. Insert Crank Handle into Crank Slot. If needed, loosen Bracket Stops and reposition roller bar to the left to make sure crank handle will clear pick up. Tighten Bracket Stops (See fig.6).

- 5.10. Close tailgate, then place bumper hook (23) under bottom of bumper. Tighten slack by pulling bumper strap (4) (See fig.7).

**5.11. LOADING**

**5.12. NOTE: Check local vehicle regulations before driving with this product attached.**

- 5.12.1. Before each use, clean pick up bed and load sheet. Dirt and debris can damage Load Sheet. Spray silicone lubricant (not included) around "L" brackets and crank slot.

- 5.12.2. Make sure tailgate is closed and latched.

- 5.12.3. **DO NOT** exceed rated weight capacity of this product.

- 5.12.4. **DO NOT** exceed rated weight capacity of pick up. Refer to pick up trucks gross vehicle weight rating.

- 5.12.5. Remove hook-and-loop straps securing Load Sheet.

- 5.12.6. Make sure Load Sheet is centred across bed.

- 5.12.7. Pull Load Sheet out to cover bed.

**NOTE: DO NOT** pull Load Sheet till the very end. Leave at least three wraps on roller bar at all times.

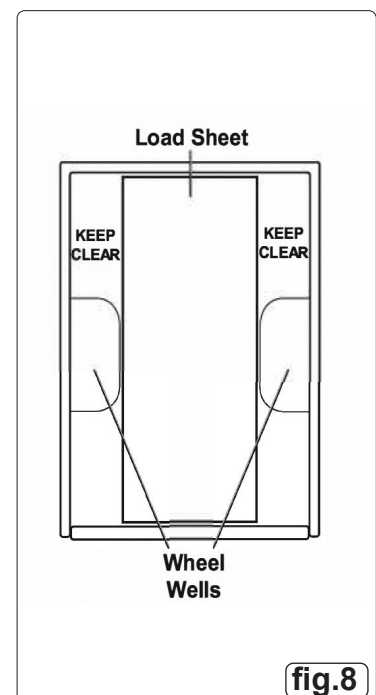
- 5.12.8. Load pick up making sure load is centred on Load Sheet and does not accumulate around wheel wells and walls. (See fig.8).

- 5.12.9. Secure Roller Bar with hook-and-loop straps.

- 5.12.9.1. A. Attach straps to each other to make one strap.

- 5.12.9.2. B. Feed strap through Crank Slot, around Bracket, then tightly secure ends together.

- WARNING!** Secure Roller Bar before driving. Failure to secure roller bar may cause the load sheet to billow while driving, causing a traffic hazard.



## UNLOADING

**NOTE:** Open tailgate cautiously, load may shift or fall while opening.

5.13. Open tailgate, attach Bumper Strap and tighten it securely.

**NOTE** The purpose of Bumper Strap is to keep tailgate from moving while unloading.

5.14. Spray silicone lubricant (not included) around "L" brackets and crank slot as necessary.

5.15. Check position of load. Move any shifted load around wheel wells and walls onto load sheet.

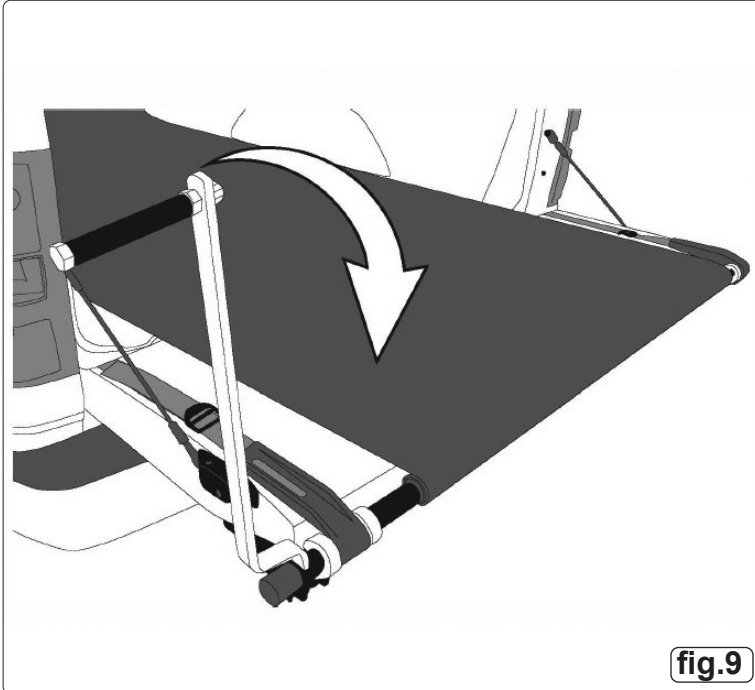
**NOTE** If moving organic materials, such as grass clippings, you may need to loosen materials (due to settling) before unloading.

5.16. Insert Crank Handle into Crank Slot and rotate Handle clockwise to unload. (See fig.9).

**NOTE: DO NOT** stand behind pick up while unloading.

5.17. After bed is unloaded, rotate handle until excess load sheet is on roller bar. Replace hook and loop straps to secure load sheet.

5.18. Close tailgate.



## 6. MAINTENANCE

### 6.1. BEFORE EACH USE

6.1.1. inspect the general condition of the unit.

6.1.2. Check for: loose hardware, misalignment or binding of moving parts, cracked or broken parts, and any other condition that may affect its safe operation.

### 6.2. AFTER EACH USE

6.2.1. clean pick up bed and load sheet. Dirt and debris can damage the load sheet. Spray silicone lubricant (not included) around "L" brackets and crank Slot.



### ENVIRONMENT PROTECTION

Recycle unwanted materials instead of disposing of them as waste. All tools, accessories and packaging should be sorted, taken to a recycling centre and disposed of in a manner which is compatible with the environment. When the product becomes completely unserviceable and requires disposal, drain any fluids (if applicable) into approved containers and dispose of the product and fluids according to local regulations.



REGISTER YOUR PURCHASE HERE

**Note:** It is our policy to continually improve products and as such we reserve the right to alter data, specifications and component parts without prior notice.

**Important:** No Liability is accepted for incorrect use of this product.

**Warranty:** Guarantee is 12 months from purchase date, proof of which is required for any claim.

Sealey Group, Kempson Way, Suffolk Business Park, Bury St Edmunds, Suffolk. IP32 7AR

01284 757500

sales@sealey.co.uk

www.sealey.co.uk